



LAMSON CENTRIFUGAL BLOWERS, 1 Lamson St. P.O. Box 4857 Syracuse, NY 13221.(315) 433-5500.  
FAX (315) 433-5451, 1 (800) 543-7736

For Approval     Certified For

# "870" Series Air & Gas, Inlet Driven Direct Drive - Dimensions

Dimensions in Inches and (mm)

Project \_\_\_\_\_  
Your Order # \_\_\_\_\_  
Our Order # \_\_\_\_\_ By \_\_\_\_\_

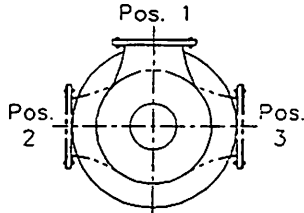

Inlet Positions  
(VIEWED FROM INLET)

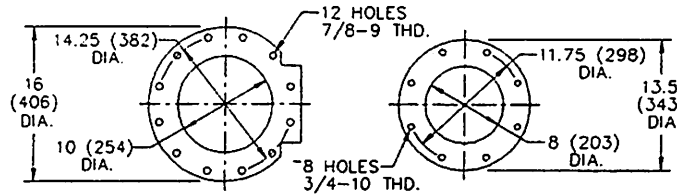

INLET      OUTLET

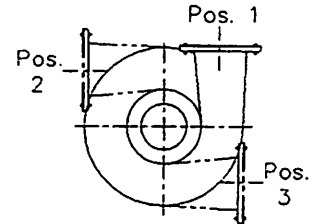

Outlet Positions  
(VIEWED FROM OUTLET)

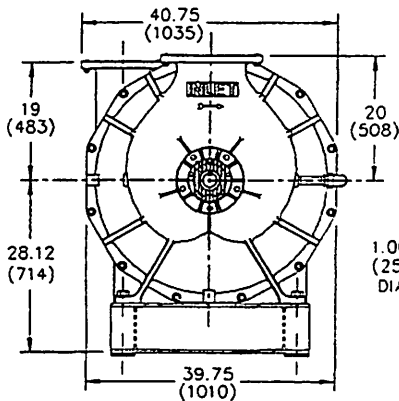

(END VIEW OF MACHINE ONLY)

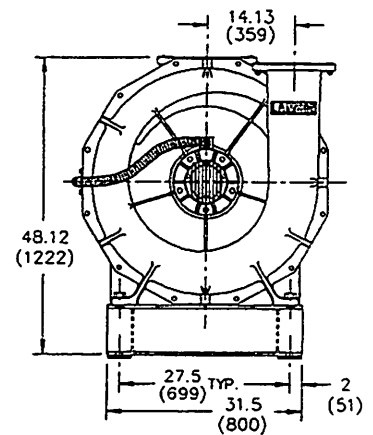
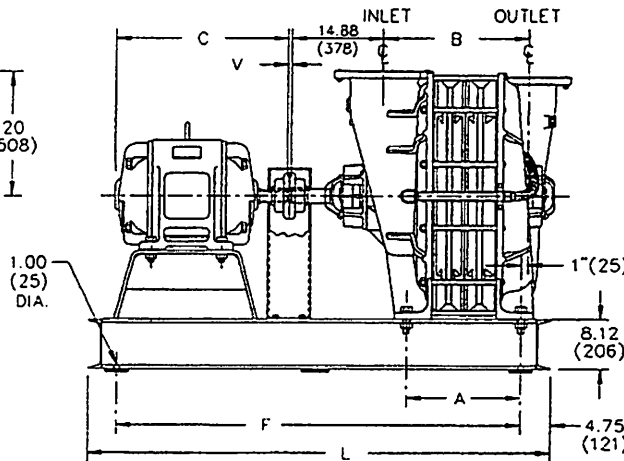

Frame No.	Dimensions				
	A	B	C	F	L
871	8.50 (216)	13.50 (343)	284TS	49.50 (1257)	59 (1499)
872	13.38 (340)	18.38 (467)	326TS	65.50 (1664)	75 (1905)
873	18.25 (464)	23.25 (591)	365TS	65.50 (1664)	75 (1905)
874	23.13 (588)	28.13 (714)	405TS	74.50 (1892)	84 (2134)
875	28.00 (711)	33.00 (838)	444TS	89.50 (2273)	99 (2515)
876	32.88 (835)	37.88 (962)	445TS	89.50 (2273)	99 (2515)
877	37.75 (959)	42.75 (1086)	445TS	94.50 (2400)	104 (2642)
878	42.63 (1083)	47.63 (1210)	447TS	105.50 (2680)	115 (2921)
879	47.50 (1207)	52.50 (1334)	447TS	105.50 (2680)	115 (2921)
*8710	52.38 (1330)	57.38 (1457)	447TS	110.50 (2807)	120 (3048)

**NOTES:**

- Column "C" lists maximum NEMA motor frame typically required for the machine indicated.
- \* Frame no. 8710 for 3000 rpm operation only.
- Motors, when viewed from the shaft end, must be suitable for counter-clockwise rotation.
- Flange dimensions conform to 125 pound ANSI cast iron flanged fittings.
- Dimension "V" is distance between shaft ends which varies depending on the coupling used. Refer to coupling data sheet for more information.
- Specifications subject to change without notice.

LAMSON CENTRIFUGAL BLOWERS, 1 Lamson St., P.O. Box 4857 Syracuse, NY 13221, (315) 433-5500,  
FAX (315) 433-5451, 1 (800) 543-7736

# "870" Series Air Outlet Driven Direct Drive - Dimensions

Dimensions in Inches and (mm)

For Approval       Certified For

Project \_\_\_\_\_

Your Order # \_\_\_\_\_

Our Order # \_\_\_\_\_ By \_\_\_\_\_

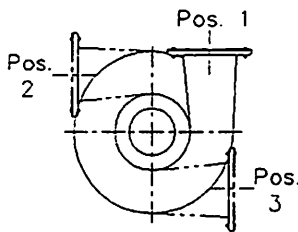

Outlet Positions  
(VIEWED FROM OUTLET)

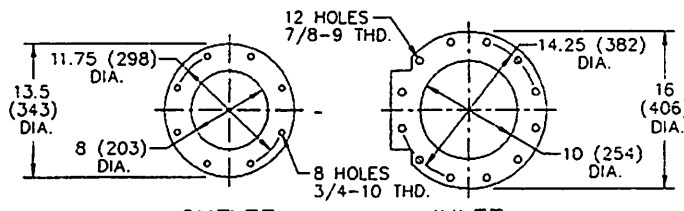

OUTLET

INLET

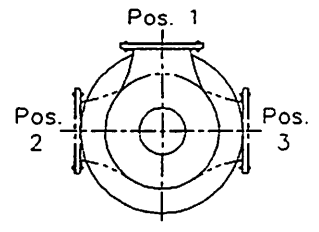

Inlet Positions  
(VIEWED FROM INLET)

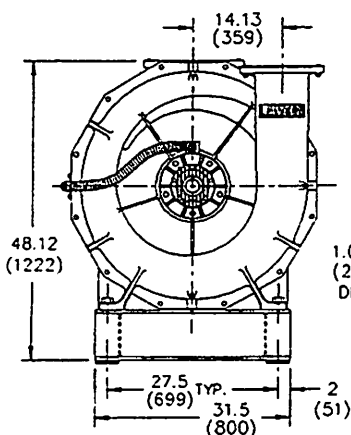

(END VIEW OF MACHINE ONLY)

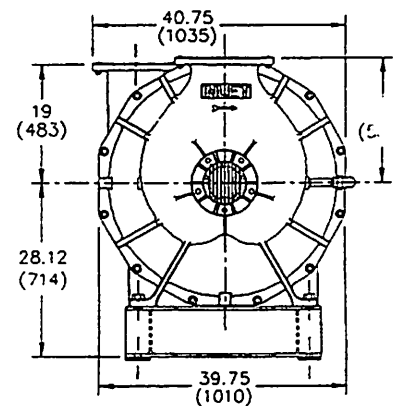
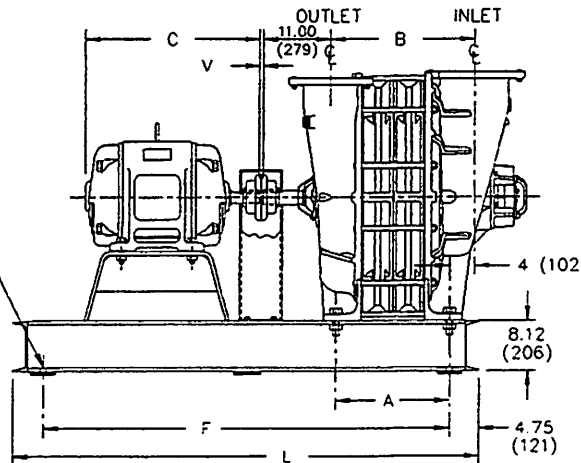

Frame No.	Dimensions				
	A	B	C	F	L
871	8.50 (216)	13.50 (343)	284TS	49.50 (1257)	59 (1499)
872	13.38 (340)	18.38 (467)	326TS	65.50 (1664)	75 (1905)
873	18.25 (464)	23.25 (591)	365TS	65.50 (1664)	75 (1905)
874	23.13 (588)	28.13 (714)	405TS	74.50 (1892)	84 (2134)
875	28.00 (711)	33.00 (838)	444TS	89.50 (2273)	99 (2515)
876	32.88 (835)	37.88 (962)	445TS	89.50 (2273)	99 (2515)
877	37.75 (959)	42.75 (1086)	445TS	94.50 (2400)	104 (2642)
878	42.63 (1083)	47.63 (1210)	447TS	105.50 (2680)	115 (2921)
879	47.50 (1207)	52.50 (1334)	447TS	105.50 (2680)	115 (2921)
*8710	52.38 (1330)	57.38 (1457)	447TS	110.50 (2807)	120 (3048)

NOTES:

- Column "C" lists maximum NEMA motor frame typically required for the machine indicated.
- \* Frame no. 8710 for 3000 rpm operation only.
- Motors, when viewed from the shaft end, must be suitable for clockwise rotation.
- Flange dimensions conform to 125 pound ANSI cast iron flanged fittings.
- Dimension "V" is distance between shaft ends which varies depending on the coupling used. Refer to coupling data sheet for more information.
- Specifications subject to change without notice.